

Havelock



**SHUGART
HOMES**

Square Feet: 2518
Bedrooms: 3
Bathrooms: 2.5

Available in Communities:
Stone Ridge
Hidden Creek
River Gate
Planter's Walk
Branch Point

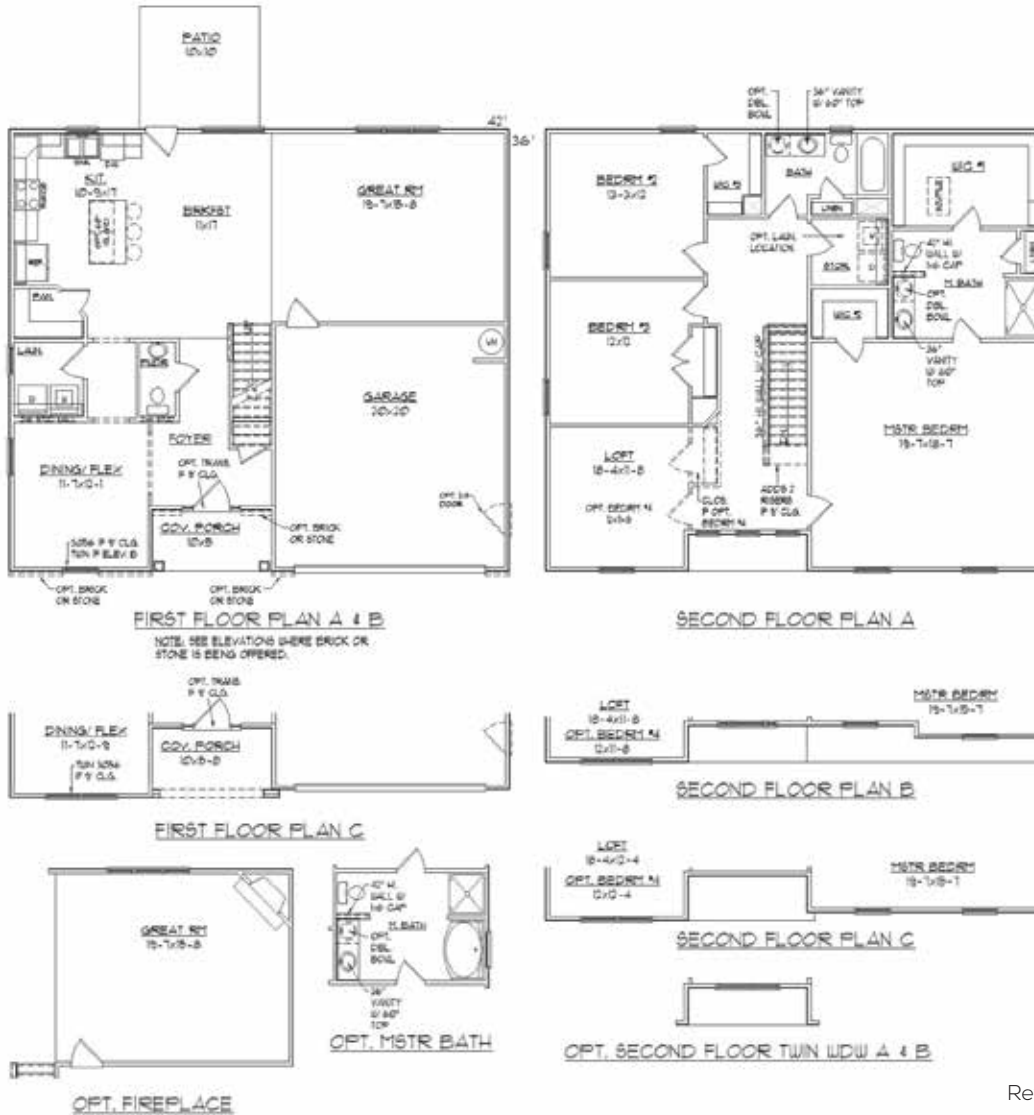

Revised 9/25/17

All dimensions are from center wall to center and are approximate.

This drawing shall remain property of Shugart Enterprises, LLC and may not be reproduced without written permission.

Plans and elevations are artist's renderings only and may contain options which are not standard on all models.

Shugart Enterprises, LLC reserves the right to make changes to floorplans, specifications, dimensions and elevations without prior notice.



Havelock



ELEV. B



OPT. TRANSOM
ELEV. B SHOWN
W/ OPT. 9' CLG.



OPT. TRANSOM
ELEV. B SHOWN W/ OPT. BRICK, OPT.
9' CLG, OPT. TWIN WDW & OPT. SHAKES



OPT. TRANSOM
ELEV. B SHOWN W/ OPT. STONE,
OPT. 9' CLG & OPT. BOARD & BATTEN



ELEV. C



OPT. TRANSOM
ELEV. C SHOWN
W/ OPT. 9' CLG.



Havelock



ELEV. A



OPT. TRANSOM
ELEV. A SHOWN
W/ OPT. 9' CLG.



OPT. TRANSOM
ELEV. A SHOWN W/ OPT. BRICK,
OPT. 9' CLG & OPT. SHAKES



OPT. TRANSOM
ELEV. A SHOWN W/ OPT. STONE,
OPT. 9' CLG & OPT. BOARD & BATTEN



OPT. TRANSOM
ELEV. A SHOWN W/ OPT. BRICK,
OPT. HIP ROOF & OPT. 9' CLG.



OPT. TRANSOM
ELEV. A SHOWN W/ OPT. STONE, OPT.
9' CLG, OPT. HIP ROOF & OPT. TWIN WDW

All dimensions are from center wall to center and are approximate.

This drawing shall remain property of Shugart Enterprises, LLC and may not be reproduced without written permission.

Plans and elevations are artist's renderings only and may contain options which are not standard on all models.

Shugart Enterprises, LLC reserves the right to make changes to floorplans, specifications, dimensions and elevations without prior notice.

